

Stand Map
Templeton Heights
Parcel # 41039Hb057
 Lane County, OR - approx. 180 acres +/-

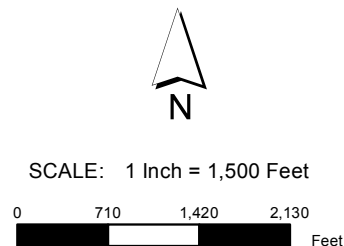
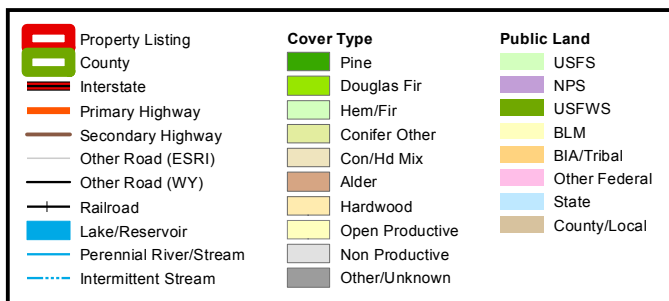

Stand #	Cover Type	Age	Acres
22	Douglas Fir	13	57.1
27	Douglas Fir	7	49.0
34	Douglas Fir	13	43.8
75	Douglas Fir	7	12.0
91	Douglas Fir	20	7.7
113	Douglas Fir	71	4.2
128	Douglas Fir	71	2.6

The property depicted on this map has not been surveyed. The acreage is an estimate based upon GIS data. The volume information in this report is based on current information in the seller's inventory system. The information is subject to change due to harvest activities and/or updates resulting from routine maintenance of the inventory system. Neither the owner nor its officers, directors, employees or agents represent or warrant the accuracy or completeness of the ownership acreage, the cover type acreage, timber inventory species, grade or volumes, legal or practical access to the property, or operability.