

**Stand Map**  
**Gleason Tract North**  
**Parcel # 41039Hb004**  
 Lane County, OR - approx. 83 acres +/-

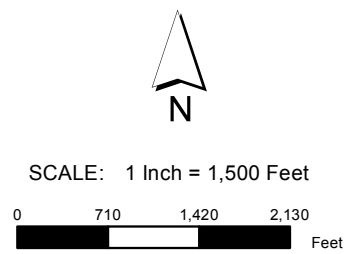
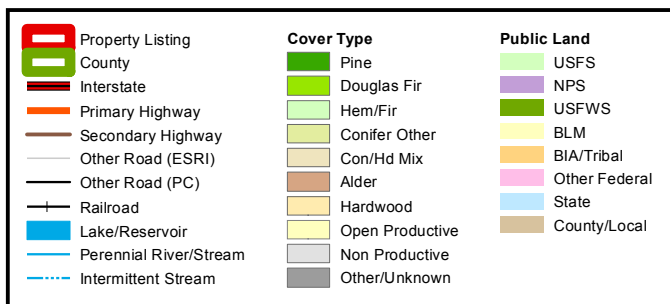

| Stand # | Cover Type     | Age | Acres |
|---------|----------------|-----|-------|
| NP      | Non Productive | NA  | 9.5   |
| 1       | Douglas Fir    | 31  | 33.6  |
| 3       | Conifer Other  | 61  | 12.8  |
| 8       | Hardwood       | 31  | 18.6  |
| 14      | Conifer Other  | 61  | 3.7   |
| 16      | Douglas Fir    | 22  | 5.0   |

The property depicted on this map has not been surveyed. The acreage is an estimate based upon GIS data. The volume information in this report is based on current information in the seller's inventory system. The information is subject to change due to harvest activities and/or updates resulting from routine maintenance of the inventory system. Neither the owner nor its officers, directors, employees or agents represent or warrant the accuracy or completeness of the ownership acreage, the cover type acreage, timber inventory species, grade or volumes, legal or practical access to the property, or operability. 1/14/2018