

**Stand Map
Shoreview
Parcel # 41039Hb104**

Lane County, OR - approx. 273 acres +/-

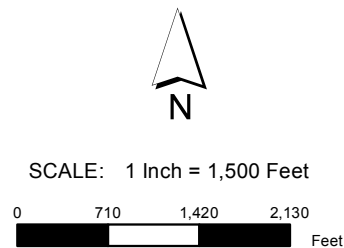
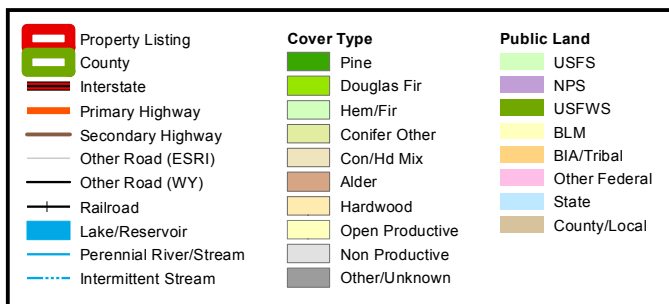

Stand #	Cover Type	Age	Acres
6	Douglas Fir	15	89.0
9	Douglas Fir	9	80.6
37	Douglas Fir	37	39.8
49	Douglas Fir	9	23.8
65	Douglas Fir	10	12.1
91	Douglas Fir	22	4.3
102	Other		4.5
120	Douglas Fir	60	3.4
130	Douglas Fir	57	2.7
142	Douglas Fir	59	1.9
154	Douglas Fir	10	1.6
155	Douglas Fir	59	1.6
170	Douglas Fir	66	1.2
183	Douglas Fir	60	1.1
358	Douglas Fir	9	3.2

The property depicted on this map has not been surveyed. The acreage is an estimate based upon GIS data. The volume information in this report is based on current information in the seller's inventory system. The information is subject to change due to harvest activities and/or updates resulting from routine maintenance of the inventory system. Neither the owner nor its officers, directors, employees or agents represent or warrant the accuracy or completeness of the ownership acreage, the cover type acreage, timber inventory species, grade or volumes, legal or practical access to the property, or operability.