

**CARLISLE**  
**Section 10, T11S, R10W**  
**Lincoln County, OR**  
**60 Acres m/l**

123°53'30"W

123°53'0"W

123°52'30"W

44°38'30"N

44°38'30"N

44°38'0"N

44°38'0"N

**Sec 03 T11S R10W**

**Sec 02 T11S R10W**

**Sec 10 T11S R10W**

**Sec 11 T11S R10W**

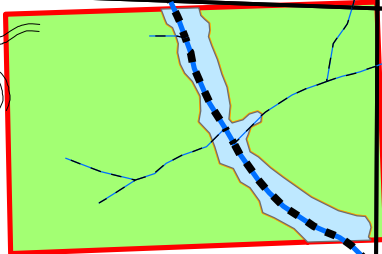

**DF Site Class**

- Site Class I
- Site Class II
- Site Class III

123°53'30"W

123°53'0"W

123°52'30"W



1 inch = 1,000 feet

- |                      |   |   |
|----------------------|---|---|
| <b>Fish Presence</b> | <b>Stream Size</b>                              | <b>Section Lines</b>  |
| ■ ■ ■ Fish           | <span style="color: blue;">—</span> Large       | <span style="border: 1px solid black; display: inline-block; width: 15px; height: 10px;"></span> RMZ          |
| - - - Unknown        | <span style="color: blue;">—</span> Medium      | <span style="border: 2px solid red; display: inline-block; width: 15px; height: 10px;"></span> Tract Boundary |
|                      | <span style="color: blue;">—</span> Small       | <span style="border: 1px solid orange; display: inline-block; width: 15px; height: 10px;"></span> Veg Types   |
|                      | <span style="color: blue;">- - -</span> Unknown |   |

**NW FOREST PROPERTIES**  
 FOREST LAND SALES & ACQUISITIONS  
[www.nwforestproperties.com](http://www.nwforestproperties.com)

**DRIFT CREEK**  
**Sections 1, T8S, R11W**  
**Lincoln County, OR**  
**80 Acres m/l**

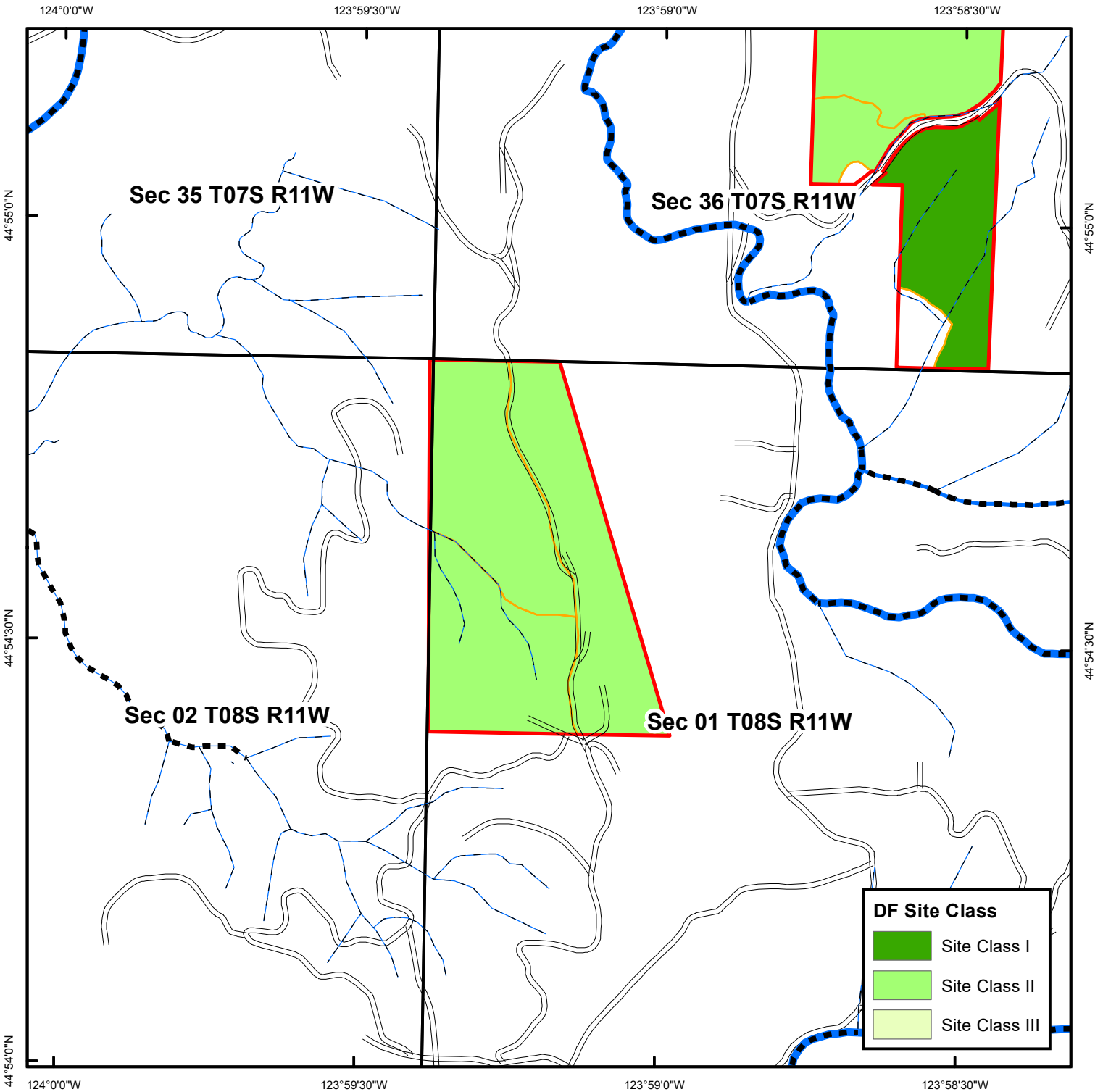

**DF Site Class**

- Site Class I
- Site Class II
- Site Class III



1 inch = 1,000 feet



- |                      |                    |                      |
|----------------------|--------------------|----------------------|
| <b>Fish Presence</b> | <b>Stream Size</b> | <b>Section Lines</b> |
| ■ ■ ■ Fish           | — Large            | □ RMZ                |
| - - - Unknown        | — Medium           | □ Tract Boundary     |
|                      | — Small            | □ Veg Types          |
|                      | - - - Unknown      |                      |



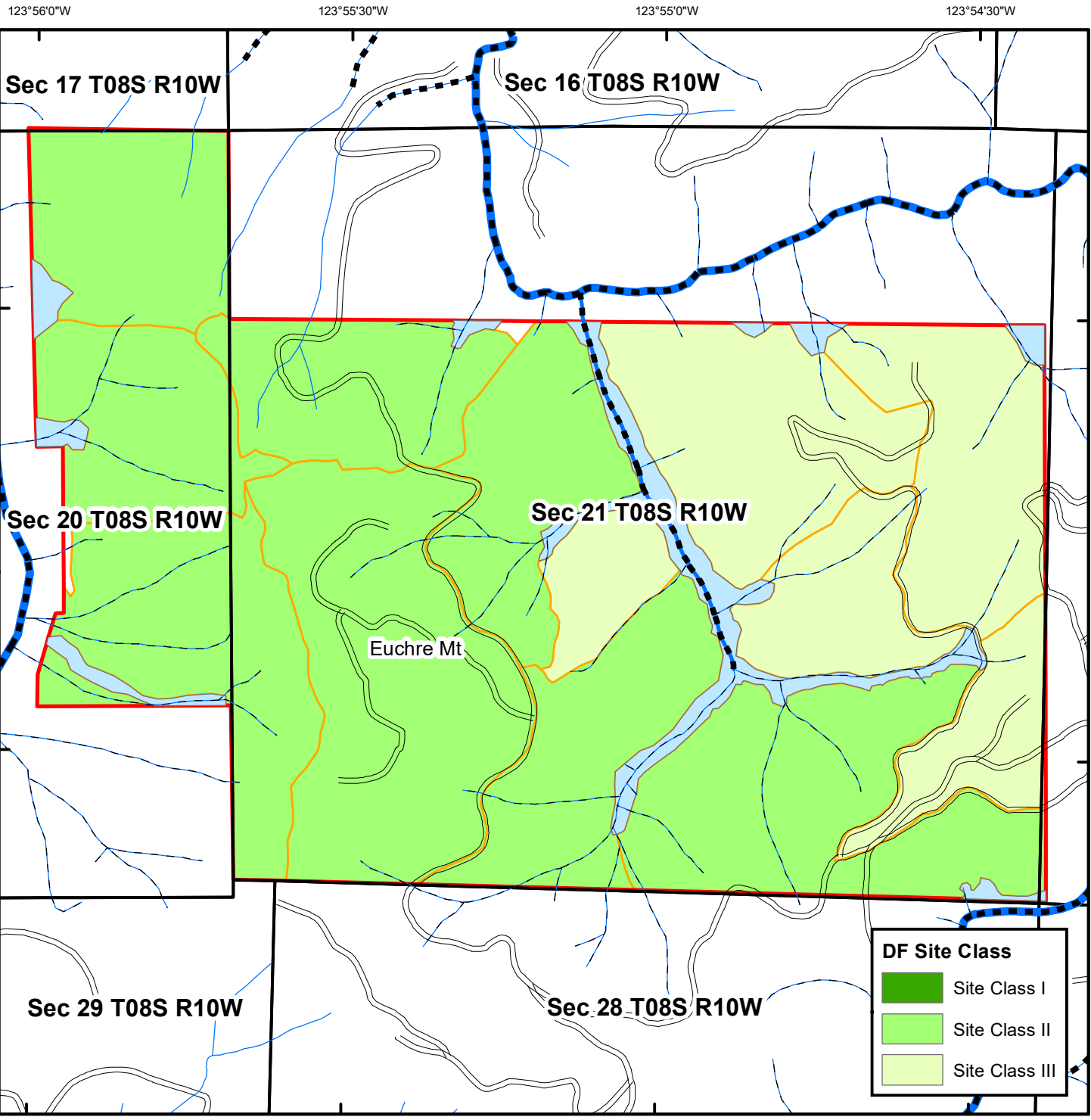





**NW FOREST PROPERTIES**  
 FOREST LAND SALES & ACQUISITIONS  
[www.nwforestproperties.com](http://www.nwforestproperties.com)

**EUCHRE MOUNTAIN**  
**Sections 20 & 21, T8S, R10W**  
**Lincoln County, OR**  
**628 Acres m/l**

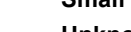

**DF Site Class**

	Site Class I
	Site Class II
	Site Class III

 1 inch = 1,000 feet	<b>Fish Presence</b>	<b>Stream Size</b>	<b>Section Lines</b>
	■ ■ ■ Fish	 Large	 Section Lines
	- - - Unknown	 Medium	 RMZ
		 Small	 Tract Boundary
	 Unknown	 Veg Types	

**PAINT CAN**  
**Sections 25 & 36, T7S, R11W**  
**Lincoln County, OR**  
**212 Acres m/l**

123°59'0"W

123°58'30"W

123°58'0"W

44°56'0"N

44°56'0"N

44°55'30"N

44°55'30"N

44°55'0"N

44°55'0"N

123°59'0"W

123°58'30"W

123°58'0"W

**Sec 25 T07S R11W**

**Sec 30 T07S R10W**

**Sec 36 T07S R11W**

**Sec 31 T07S R10W**

**Sec 06**

**DF Site Class**

- Site Class I
- Site Class II
- Site Class III



1 inch = 1,000 feet

- |                      |   |   |
|----------------------|---|---|
| <b>Fish Presence</b> | <b>Stream Size</b>                              | <b>Section Lines</b>  |
| ■ ■ ■ Fish           | <span style="color: blue;">—</span> Large       | <span style="border: 1px solid black; display: inline-block; width: 15px; height: 10px;"></span> RMZ          |
| - - - Unknown        | <span style="color: blue;">—</span> Medium      | <span style="border: 2px solid red; display: inline-block; width: 15px; height: 10px;"></span> Tract Boundary |
|                      | <span style="color: blue;">—</span> Small       | <span style="border: 1px solid orange; display: inline-block; width: 15px; height: 10px;"></span> Veg Types   |
|                      | <span style="color: blue;">- - -</span> Unknown |   |

**NW FOREST PROPERTIES**  
 FOREST LAND SALES & ACQUISITIONS  
[www.nwforestproperties.com](http://www.nwforestproperties.com)

**SAM'S CREEK**  
**Sections 10, T10S, R9W**  
**Lincoln County, OR**  
**80 Acres m/l**

123°47'30"W                      123°47'0"W                      123°46'30"W

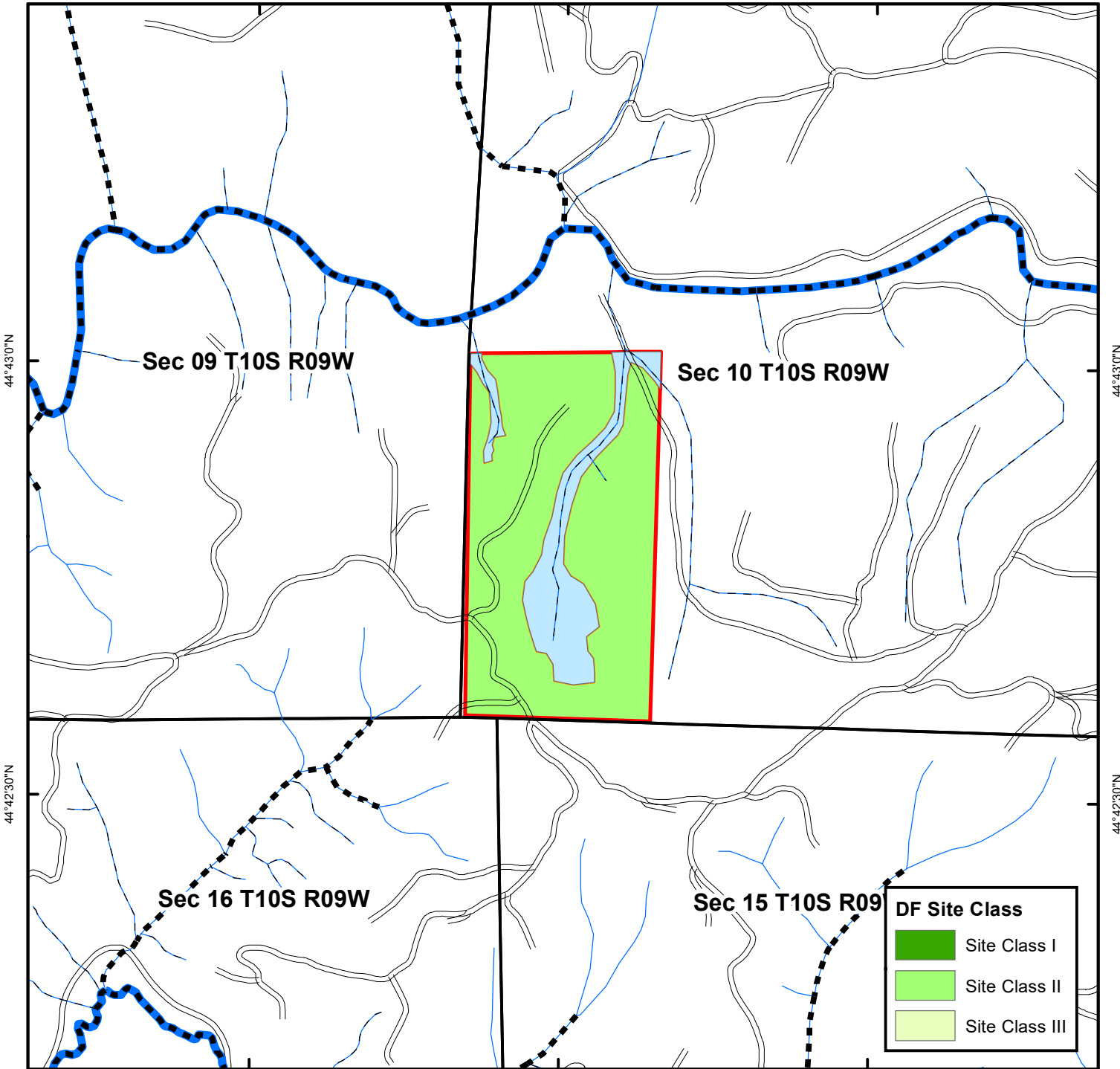

44°43'0"N

44°43'0"N

44°42'30"N

44°42'30"N

123°47'30"W                      123°47'0"W                      123°46'30"W

**DF Site Class**

- Site Class I
- Site Class II
- Site Class III



1 inch = 1,000 feet

- |                      |  |   |
|----------------------|--|---|
| <b>Fish Presence</b> | <b>Stream Size</b>   | <b>Section Lines</b>  |
| ■ ■ ■ Fish           | <span style="color: blue; font-weight: bold;">—</span> Large       | <span style="border: 1px solid black; display: inline-block; width: 15px; height: 10px;"></span> RMZ          |
| - - - Unknown        | <span style="color: blue; font-weight: bold;">—</span> Medium      | <span style="border: 2px solid red; display: inline-block; width: 15px; height: 10px;"></span> Tract Boundary |
|                      | <span style="color: blue; font-weight: bold;">—</span> Small       | <span style="border: 1px solid orange; display: inline-block; width: 15px; height: 10px;"></span> Veg Types   |
|                      | <span style="color: blue; font-weight: bold;">- - -</span> Unknown |   |

**NW FOREST PROPERTIES**  
 FOREST LAND SALES & ACQUISITIONS  
[www.nwforestproperties.com](http://www.nwforestproperties.com)

**SCHOONER**  
**Section 30, T7S, R10W**  
**Lincoln County, OR**  
**80 Acres m/l**

123°58'0"W

123°57'30"W

123°57'0"W

123°56'30"W

44°56'30"N

44°56'30"N

44°56'0"N

44°56'0"N

44°55'30"N



44°55'30"N

**Sec 30 T07S R10W**

**Sec 29 T07S R10W**

**Sec 31 T07S R10W**

**Site Class**

-  Site Class I
-  Site Class II
-  Site Class III

123°58'0"W











123°57'30"W

123°57'0"W

123°56'30"W



1 inch = 1,000 feet

- |  |  |   |
|--|--|---|
| <b>Fish Presence</b>   | <b>Stream Size</b>   |  <b>Section Lines</b>  |
|  <b>Fish</b>    |  <b>Large</b>   |  <b>RMZ</b>            |
|  <b>Unknown</b> |  <b>Medium</b>  |  <b>Tract Boundary</b> |
|  |  <b>Small</b>   |  <b>Veg Types</b>      |
|  |  <b>Unknown</b> |   |



**NW FOREST PROPERTIES**  
 FOREST LAND SALES & ACQUISITIONS  
[www.nwforestproperties.com](http://www.nwforestproperties.com)

**SILETZ EAST**  
**Sections 31 & 32, T9S, R9W**  
**Lincoln County, OR**  
**220 Acres m/l**

123°50'0"W

123°49'30"W

123°49'0"W

**Sec 30 T09S R09W**

**Sec 29 T09S R09W**

**Sec 31 T09S R09W**

**Sec 32 T09S R09W**

**Sec 06 T10S R09W**

**Sec 05 T10S R09W**

123°50'0"W

123°49'30"W

123°49'0"W

44°45'0"N

44°45'0"N

44°44'30"N

44°44'30"N

**DF Site Class**

- Site Class I
- Site Class II
- Site Class III



1 inch = 1,000 feet

- |                      |  |                      |
|----------------------|--|----------------------|
| <b>Fish Presence</b> | <b>Stream Size</b>   | <b>Section Lines</b> |
| ■ ■ ■ Fish           | <span style="color: blue; font-weight: bold;">—</span> Large   | □ EX                 |
| - - - Unknown        | <span style="color: blue; font-weight: bold;">—</span> Medium  | □ RMZ                |
|                      | <span style="color: blue; font-weight: bold;">—</span> Small   | □ Tract Boundary     |
|                      | <span style="color: blue; font-weight: bold;">—</span> Unknown | □ Veg Types          |

**NW FOREST PROPERTIES**  
 FOREST LAND SALES & ACQUISITIONS  
[www.nwforestproperties.com](http://www.nwforestproperties.com)

**SILETZ WEST**  
**Sections 1 & 2, T10S, R10W**  
**Lincoln County, OR**  
**192 Acres m/l**

123°53'0"W

123°52'30"W

123°52'0"W

123°51'30"W

44°44'30"N

**Sec 35 T09S R10W**

**Sec 36 T09S R10W**

44°44'30"N

44°44'0"N

**Sec 02 T10S R10W**

**Sec 01 T10S R10W**

44°44'0"N

44°43'30"N

123°53'0"W

123°52'30"W

123°52'0"W

123°51'30"W

**DF Site Class**

- Site Class I
- Site Class II
- Site Class III



1 inch = 1,000 feet

- |                      |   |   |
|----------------------|---|---|
| <b>Fish Presence</b> | <b>Stream Size</b>                              | <b>Section Lines</b>  |
| ■ ■ ■ Fish           | <span style="color: blue;">—</span> Large       | <span style="border: 1px solid black; display: inline-block; width: 15px; height: 10px;"></span> RMZ          |
| - - - Unknown        | <span style="color: blue;">—</span> Medium      | <span style="border: 2px solid red; display: inline-block; width: 15px; height: 10px;"></span> Tract Boundary |
|                      | <span style="color: blue;">—</span> Small       | <span style="border: 1px solid orange; display: inline-block; width: 15px; height: 10px;"></span> Veg Types   |
|                      | <span style="color: blue;">- - -</span> Unknown |   |

**NW FOREST PROPERTIES**  
 FOREST LAND SALES & ACQUISITIONS  
[www.nwforestproperties.com](http://www.nwforestproperties.com)